

CRICHTON
P L A C E
on L street

*Townhomes
in
Downtown Fresno*

Crichton Place is a 28-unit all-townhome gated community located within the Mural District at the corner of L and San Joaquin Streets in Downtown Fresno. It will offer units at 1,423 square feet, 2-Story Townhomes with 3 spacious Bedrooms, 2.5 Baths, an attached 2-car Garage, private covered Patios (select units) and plenty of storage space.

Inside this community you will find a cozy landscaped courtyard perfect for resident enjoyment of all occasions. In addition, Crichton Place will feature amenities for the perfect living space. The result will be energy-efficient Townhomes with fully equipped kitchens, quartz countertops, ceiling fans, energy-efficient appliances and the latest GV Eco-Smart technologies.



Floor Plans

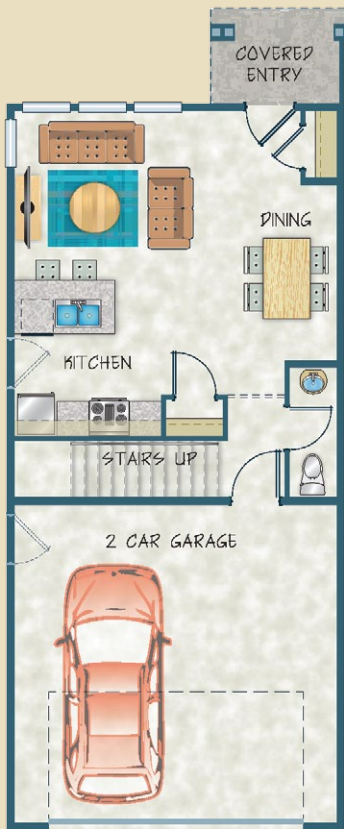

First Floor

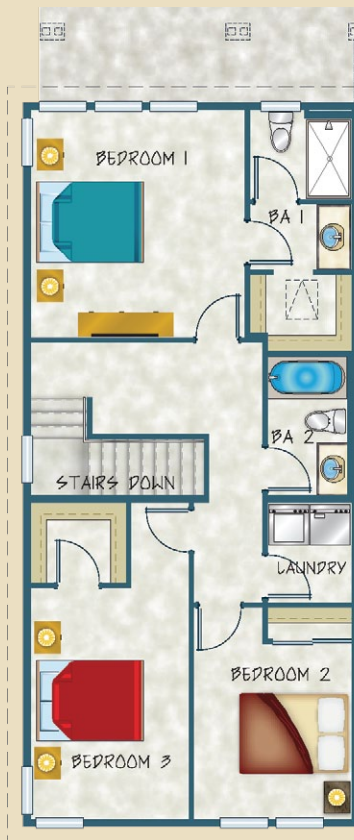

Second Floor

Site Plan



Amenities

- Located in the Mural District
- 1,423 s.f. Townhomes with 3 Bedrooms, 2.5 Baths and an Attached Garage
- 24/7 Emergency Maintenance Service
- Landscaped Courtyard with Garden Boxes and Covered Patio (*perfect for entertaining*)
- Private Patios (*select units*)
- Private Gated Community
- Pet-Friendly with Designated Doggy Potty Areas
- Professional Property Management
- Granville Eco-Smart Technology Interior Features
- Fully Equipped Kitchen w/ White Quartz Countertops
- Exposed Concrete Epoxy Floors (*first floor*)
- Karndean Wood Flooring (*select areas*)
- Carpet in Bedrooms
- Energy Efficient Appliances
- Ceiling Fans
- Cable TV & Internet Ready
- Full Side-by-Side Washer/Dryer Hookups (*rentable appliance options*)
- Lots of Storage Space